

BK PG

5740 051

FILED IN OFFICE
CLERK OF SUPERIOR COURT
CHEROKEE COUNTY, GA

02 DEC 13 PM 2:26

BOOK 5740 PAGE 051
Anne M. Lencz

CLERK AFTER RECORDING
RETURN DOCUMENTS TO:
SELLERS & WARREN, P.C.
101 WOODLAND WAY, STE 1A
CANTON, GA 30114

4/8

2002

52669

CO20196

Above Space Reserved for Recording

After Recording, Return To:
William T. McKenzie, Esq.
Burr & Forman LLP
One Georgia Center, Suite 1200
600 West Peachtree Street, NW
Atlanta, Georgia 30308

Reference:
Declaration of Protective
Covenants, Etc. - Deed Book 2918,
Page 244, Cherokee County, Georgia
records, as amended

NOTE: THIS DOCUMENT ANNEXES AND SUBMITS ADDITIONAL
PROPERTY TO THE PROVISIONS OF THE DECLARATION OF
PROTECTIVE COVENANTS, CONDITIONS, RESTRICTIONS AND
EASEMENTS FOR BRIDGEMILL

**AMENDMENT TO THE DECLARATION OF PROTECTIVE
COVENANTS, CONDITIONS, RESTRICTIONS AND EASEMENTS
FOR BRIDGEMILL**

THIS AMENDMENT is made this 10th day of December, 2002, by **BRIDGEMILL,
LLC**, a Georgia limited liability company (hereinafter "Declarant");

WITNESSETH:

WHEREAS, on December 4, 1997, Declarant filed of record that certain Declaration of
Protective Covenants, Conditions, Restrictions and Easements for BridgeMill, which was
recorded at Deed Book 2918, Page 244 et seq, Cherokee County, Georgia records (hereinafter
the "Original Declaration"), which has been amended from time to time (as amended, the
"Declaration");

WHEREAS, the real property described on Exhibit "A" attached hereto is owned by
Fields Landing, LLC, and is adjacent to the real property described in Exhibit "C" to the Original
Declaration;

WHEREAS, Declarant, with the consent of Fields Landing, LLC, desires to annex and
submit to the Declaration the real property described on Exhibit "A" hereto;

NOW, THEREFORE, pursuant to Section 2.2 of the Declaration and the powers retained by Declarant pursuant to Section 11.1(a) of the Declaration, Declarant, with the consent of Fields Landing, LLC as the owner thereof, hereby annexes and submits to the provisions of the Declaration the real property described on Exhibit "A" attached hereto.

IN WITNESS WHEREOF, Declarant, with the consent of Fields Landing, LLC, has caused this Amendment to be executed as of the day and year first above written.

Signed, sealed and delivered
this 16th day of December,
2002, in the presence of:

Sonya R. Lowe
Witness

James R. Grier
Notary Public
[NOTARIAL SEAL]
My Commission Expires: Jan 06, 2003
CHEROKEE COUNTY, GA

DECLARANT:

BRIDGEMILL, LLC, a Georgia limited liability company
(formerly known as Gold Mill, LLC)

By: Jefferson Development Company,
a Texas corporation, its Manager

By: Don W. Davis
Vice President
[CORPORATE SEAL]
JEFFERSON DEVELOPMENT COMPANY
CORPORATE SEAL
TEXAS

Signed, sealed and delivered
this 16th day of December,
2002, in the presence of:

Sonya R. Lowe
Witness

James R. Grier
Notary Public
[NOTARIAL SEAL]
My Commission Expires: Jan 06, 2003
CHEROKEE COUNTY, GA

CONSENTED TO:

FIELDS LANDING, LLC, a Georgia limited liability company

By: B. Brett Blewins
Name: B. BRETT BLEWINS
Title: MANAGER

EXHIBIT "C" (Page 1 of 4)

BridgeMill/Fields Landing - Tract 6

ALL THAT TRACT OR PARCEL OF LAND lying and being in Land Lots 5, 67 & 68 of the 15th District, 2nd Section, and Land Lot 54 of the 14th District, 2nd Section, Cherokee County, Georgia, and being more particularly described as follows:

Beginning at the southeast corner of Land Lot 68 and a U.S. Army Corps of Engineers Monument;

Thence along the south line of Land Lot 68, running North 89 degrees 40 minutes 50 seconds West, 659.21 feet to a 1 inch crimp top pipe found;

Thence leaving said Land Lot line, and running North 01 degrees 04 minutes 14 seconds East, 1332.17 feet to a 1-1/4 inch open top pipe found;

Thence running North 00 degrees 57 minutes 36 seconds West, 727.18 feet to a 1-1/4 inch crimp top pipe found;

Thence running South 87 degrees 54 minutes 41 seconds East, 306.02 feet to a 1-5/8 inch open top pipe found;

Thence running North 01 degrees 20 minutes 02 seconds East, 615.44 feet to a 2-1/4 inch open top pipe found on the north line of Land Lot 5;

Thence along said Land Lot line, South 89 degrees 51 minutes 31 seconds West, 4.97 feet to a 1-1/2 inch crimp top pipe found;

Thence leaving said Land Lot line, and running North 22 degrees 15 minutes 31 seconds West, 76.74 feet to a point on the southern right-of-way of Fields Landing Drive (50' R/W);

Thence along said right-of-way and a curve to the left, an arc distance of 151.56 feet, said curve having a radius of 988.57 feet and being subtended by a chord of 151.41 feet, at North 39 degrees 11 minutes 55 seconds East, to a point;

Thence leaving said right-of-way, running South 88 degrees 24 minutes 27 seconds East, 625.61 feet to a point;

Thence running South 09 degrees 50 minutes 00 seconds West, 168.16 feet to a point on the north line of Land Lot 6;

Thence along said Land Lot line, South 88 degrees 42 minutes 42 seconds West, 294.18 feet to a 3/4 inch open top pipe found at the northeast corner of Land Lot 5;

Thence along the east line of Land Lot 5, running South 01 degrees 00 minutes 51 seconds West, 293.74 feet to a point;

Thence leaving said Land Lot line, and running along a curve to the left, an arc distance of 100.43 feet, said curve having a radius of 252.92 feet and being subtended by a chord of 99.77 feet, at South 14 degrees 02 minutes 31 seconds West, to a point;

BK PG
5740 054

EXHIBIT "C" (Page 2 of 4)

BridgeMill/Fields Landing - Tract 6 [continued]

Thence running South 02 degrees 40 minutes 00 seconds West, 108.04 feet to a point;

Thence along a curve to the left, an arc distance of 223.19 feet, said curve having a radius of 1565.86 feet and being subtended by a chord of 223.00 feet, at South 01 degrees 25 minutes 00 seconds east, to a point;

Thence running South 05 degrees 30 minutes 00 seconds East, 142.33 feet to a point on the east line of Land Lot 5;

Thence along said Land Lot line, running South 01 degrees 00 minutes 51 seconds West, 478.44 feet to a 1-1/4 inch open top pipe found at the southeast corner of Land Lot 5;

Thence along the north line of Land Lot 67, running South 89 degrees 06 minutes 40 seconds East, 241.23 feet to a point;

Thence leaving said Land Lot line, and running along a curve to the right, an arc distance of 50.78 feet, said curve having a radius of 381.40 feet and being subtended by a chord of 50.74 feet, at South 17 degrees 05 minutes 18 seconds West, to a point;

Thence running North 76 degrees 16 minutes 38 seconds East, 59.17 feet to a point;

Thence running South 67 degrees 24 minutes 00 seconds East, 200.00 feet to a point;

Thence running South 41 degrees 03 minutes 30 seconds East, 290.48 feet to a point;

Thence running South 00 degrees 45 minutes 32 seconds West, 336.16 feet to a point;

Thence running North 89 degrees 34 minutes 00 seconds West, 660.00 feet to a U.S. Army Corps of Engineers Monument on the west line of Land Lot 67;

Thence along said Land Lot line, running South 00 degrees 46 minutes 20 seconds West, 658.91 feet to a U.S. Army Corps of Engineers Monument at the southeast corner of Land Lot 68, said point being the POINT OF BEGINNING;

Said tract or parcel of land contains 47.40 acres, and is shown as "Tract 6" on that certain Survey for BridgeMill, LLC and Fields Landing, LLC, dated October 14, 2002, by Gaskins Surveying & Engineering Company.

EXHIBIT "C" (Page 3 of 4)**BridgeMill/Fields Landing - Tract 2**

ALL THAT TRACT OR PARCEL OF LAND lying and being in Land Lot 6 of the 15th District, 2nd Section, Cherokee County, Georgia, and being more particularly described as follows:

Beginning at the northwest corner of Land Lot 6 of the 15th District, 2nd Section, aforesaid County, at a "3/4 inch open top pipe" found, said point being the POINT OF BEGINNING;

Thence along the north line of said Land Lot 6, running North 88 degrees 42 minutes 42 seconds East, 294.18 feet to a point;

Thence leaving said Land Lot line, and running South 09 degrees 50 minutes 00 seconds West, 162.04 feet to a point;

Thence running along a curve to the left having a radius of 252.92 feet and an arc length of 328.50 feet, said curve being subtended by a chord bearing of South 62 degrees 37 minutes 31 seconds West, a chord distance of 305.89 feet to a point;

Thence running North 01 degrees 00 minutes 51 seconds East, 293.74 feet to a "3/4 inch open top pipe" found at the northwest corner of Land Lot 6, said point being the POINT OF BEGINNING.

Said tract or parcel of land contains 1.20 acres, and is shown as "Tract 2" on that certain Survey for BridgeMill, LLC and Fields Landing, LLC, dated October 14, 2002, by Gaskins Surveying & Engineering Company.

COPY

BK PG
5740 056

EXHIBIT "C" (Page 4 of 4)

BridgeMill/Fields Landing - Tract 4

ALL THAT TRACT OR PARCEL OF LAND lying and being in Land Lot 6 of the 15th District, 2nd Section, Cherokee County, Georgia, and being more particularly described as follows:

TO FIND THE TRUE POINT OF BEGINNING, begin at the northwest corner of Land Lot 6, of the 15th District, 2nd Section, aforesaid County, at a "3/4 inch open top pipe" found; thence along the west line of Land Lot 6, South 01 degrees 00 minutes 51 seconds West, 863.15 feet to a point, said point being the TRUE POINT OF BEGINNING;

Thence leaving said line of Land Lot 6, and running South 05 degrees 30 minutes 00 seconds East, 112.67 feet to a point;

Thence along a curve to the left having a radius of 305.01 feet and an arc length of 363.60 feet, said curve being subtended by a chord bearing of South 39 degrees 39 minutes 04 seconds East, a chord distance of 342.45 feet to a point;

Thence running South 32 degrees 00 minutes 00 seconds East, 30.53 feet to a point;

Thence running South 07 degrees 48 minutes 00 seconds West, 43.00 feet to a point;

Thence along a curve to the right having a radius of 381.40 feet and an arc length of 36.44 feet, said curve being subtended by a chord bearing of South 10 degrees 32 minutes 13 seconds West, a chord distance of 36.42 feet to a point on the south line of Land Lot 6;

Thence along the south line of Land Lot 6, running North 89 degrees 06 minutes 40 seconds West, 241.23 feet to a "1-1/4 inch open top pipe" found at the southwest corner of Land Lot 6;

Thence along the west line of Land Lot 6, running North 01 degrees 00 minutes 51 seconds East, 478.44 feet to a point, said point being the TRUE POINT OF BEGINNING.

Said tract or parcel of land contains 1.08 acres, and is shown as "Tract 4" on that certain Survey for BridgeMill, LLC and Fields Landing, LLC, dated October 14, 2002, by Gaskins Surveying & Engineering Company.

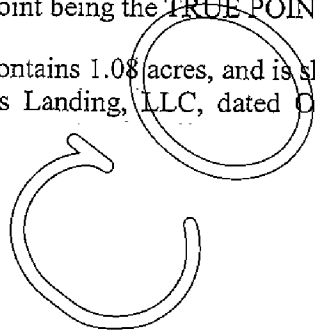

Rec 2-27-03